

A/26642/1978  
 Planning Permit No. A/26642/13.7.78  
**APPROVED**  
 SUBJECT TO THE CONDITIONS IN THIS ORDER LETTER.  
 FOR MEMBER SECRETARY  
 CHENNAI METROPOLITAN  
 DEVELOPMENT AUTHORITY  
 CHENNAI - 600 005.

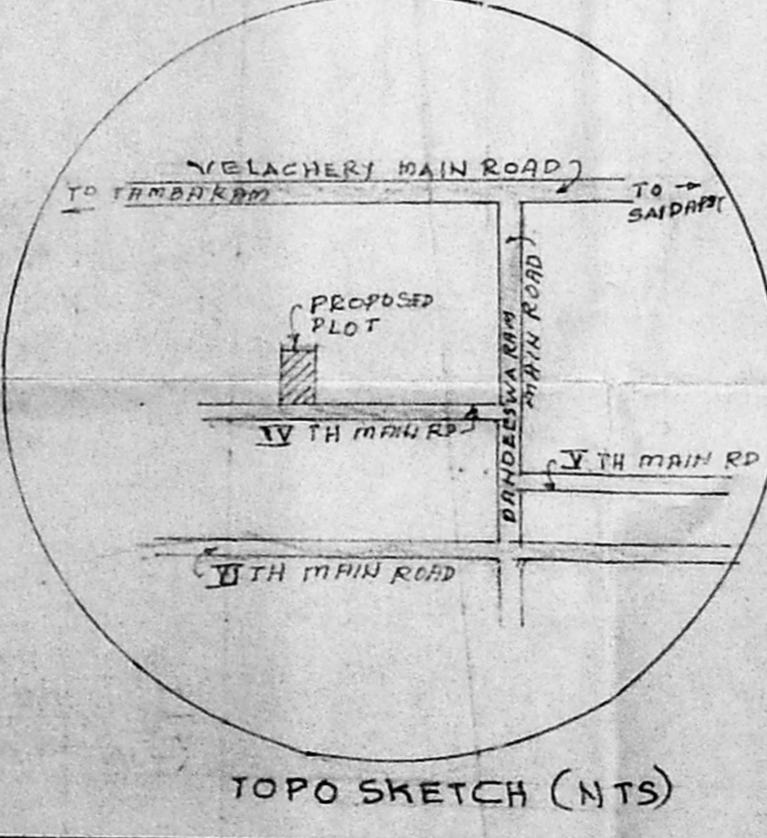
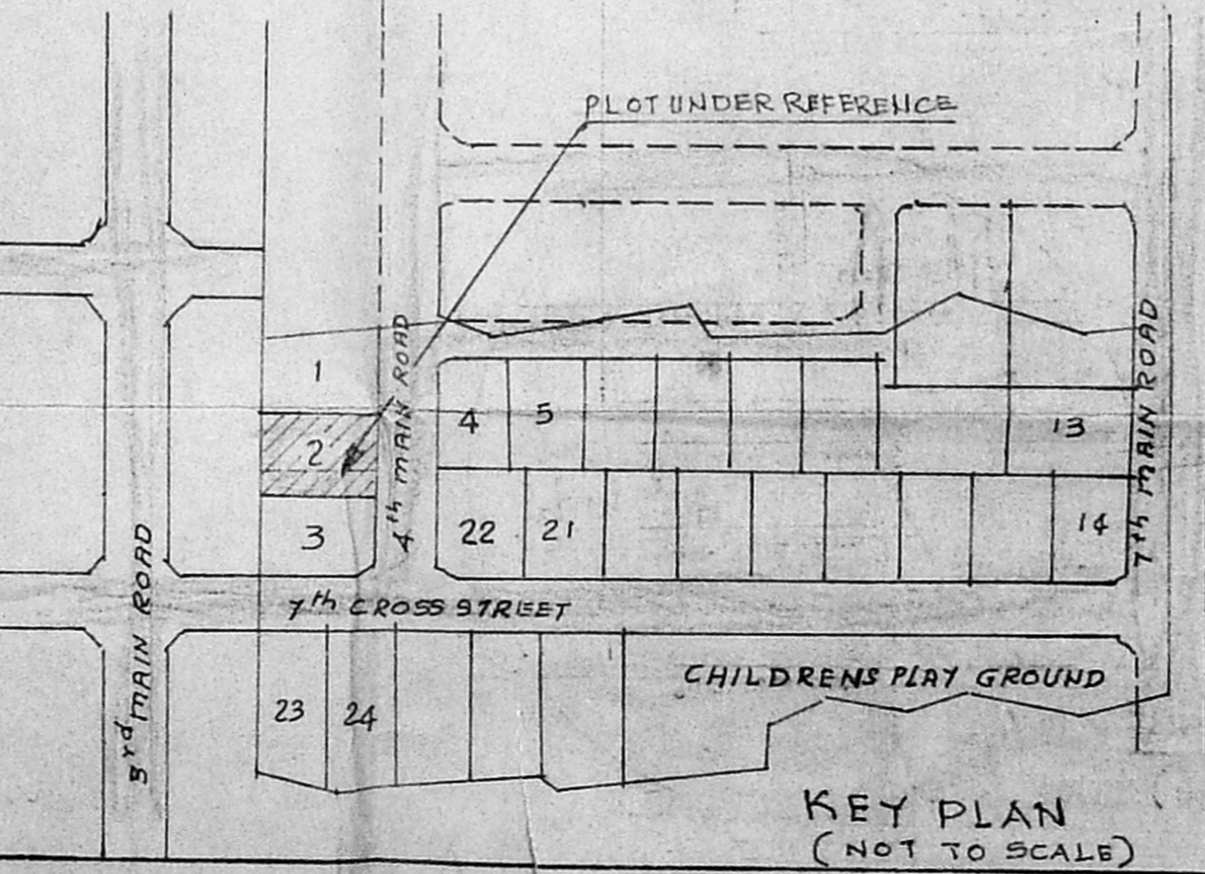
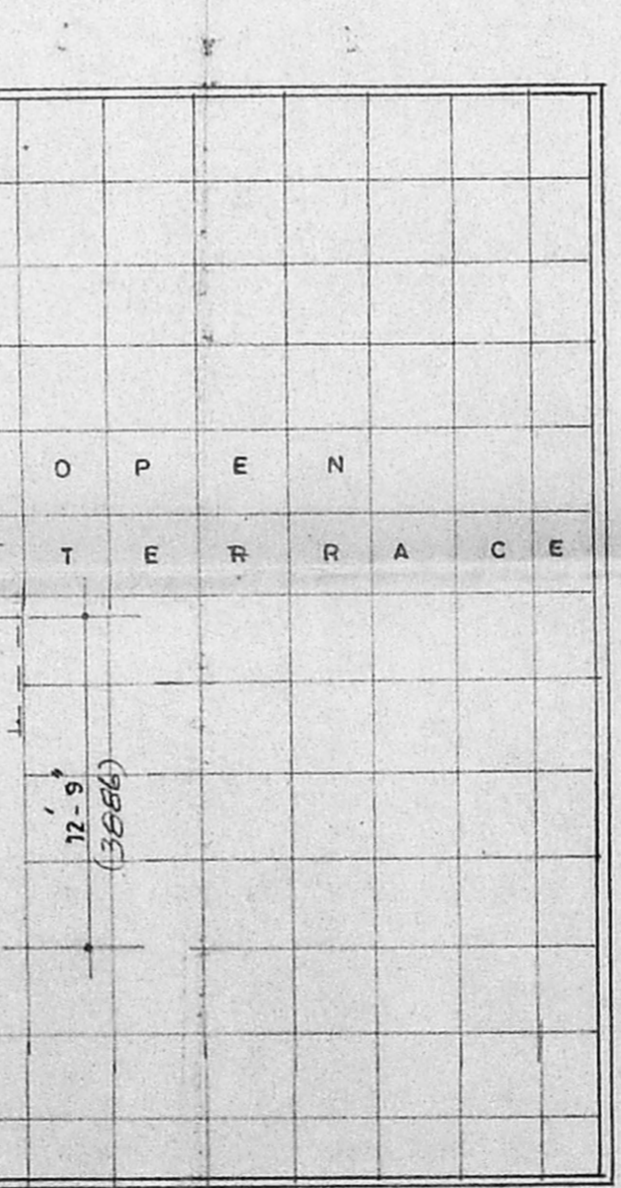
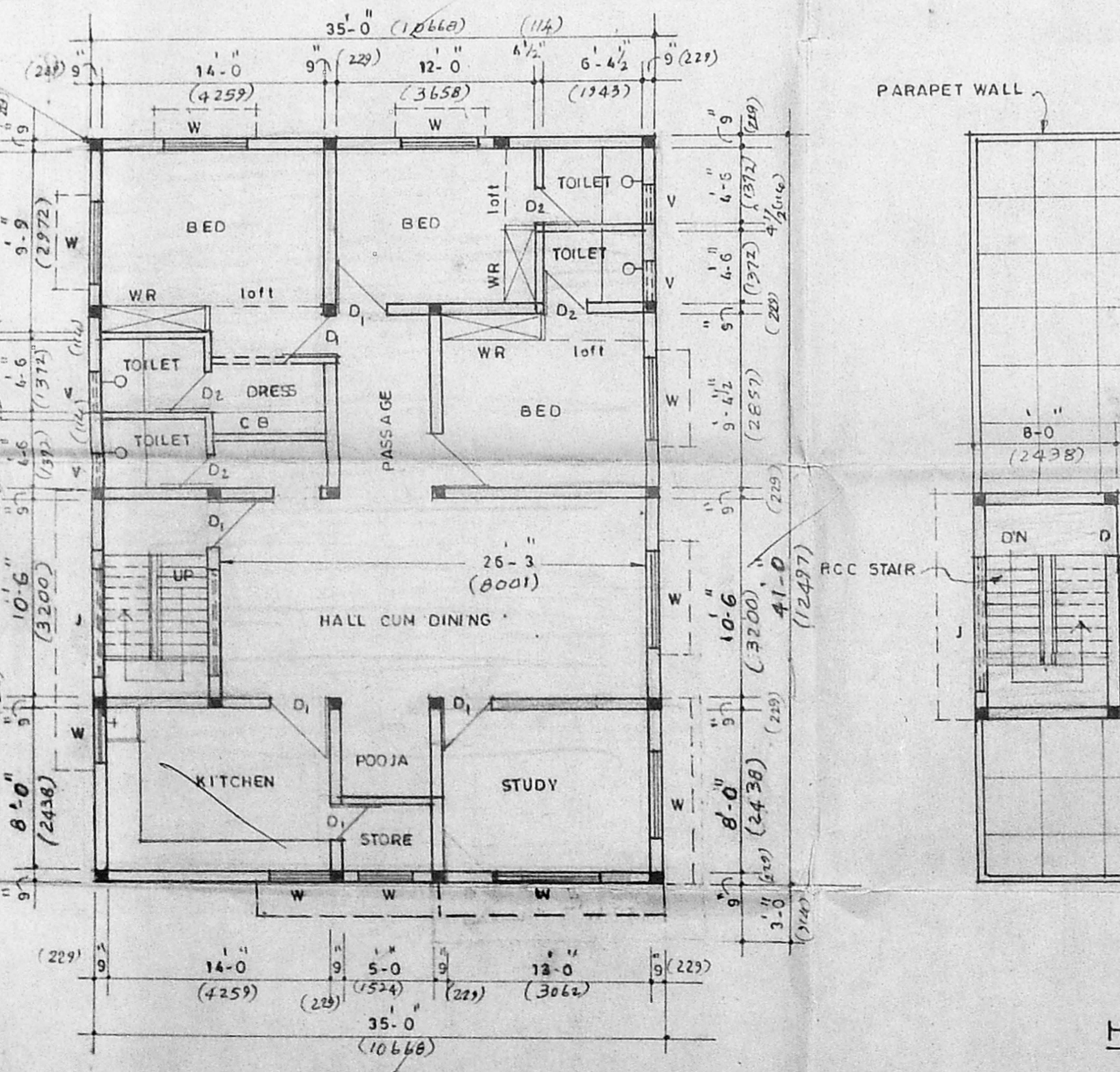
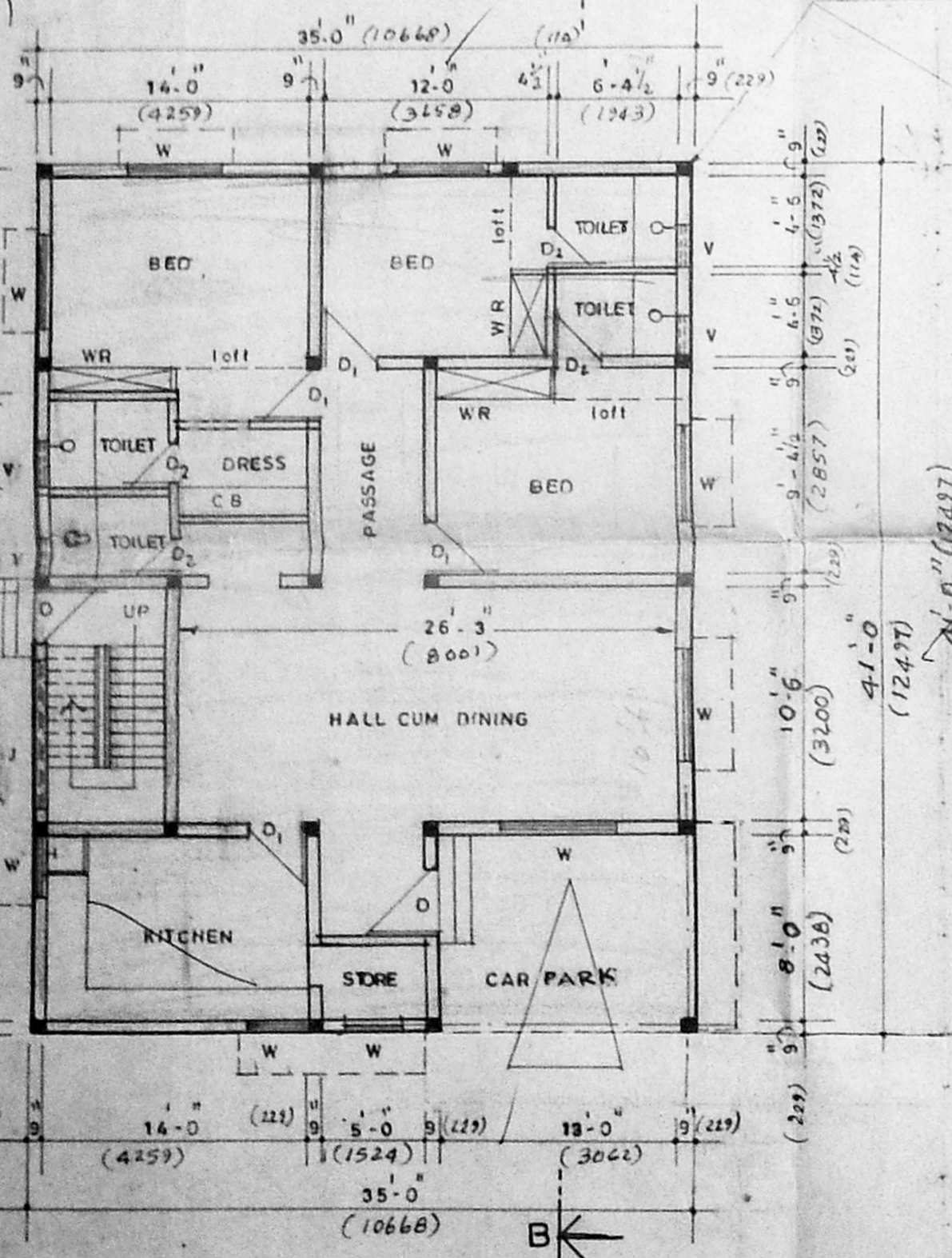
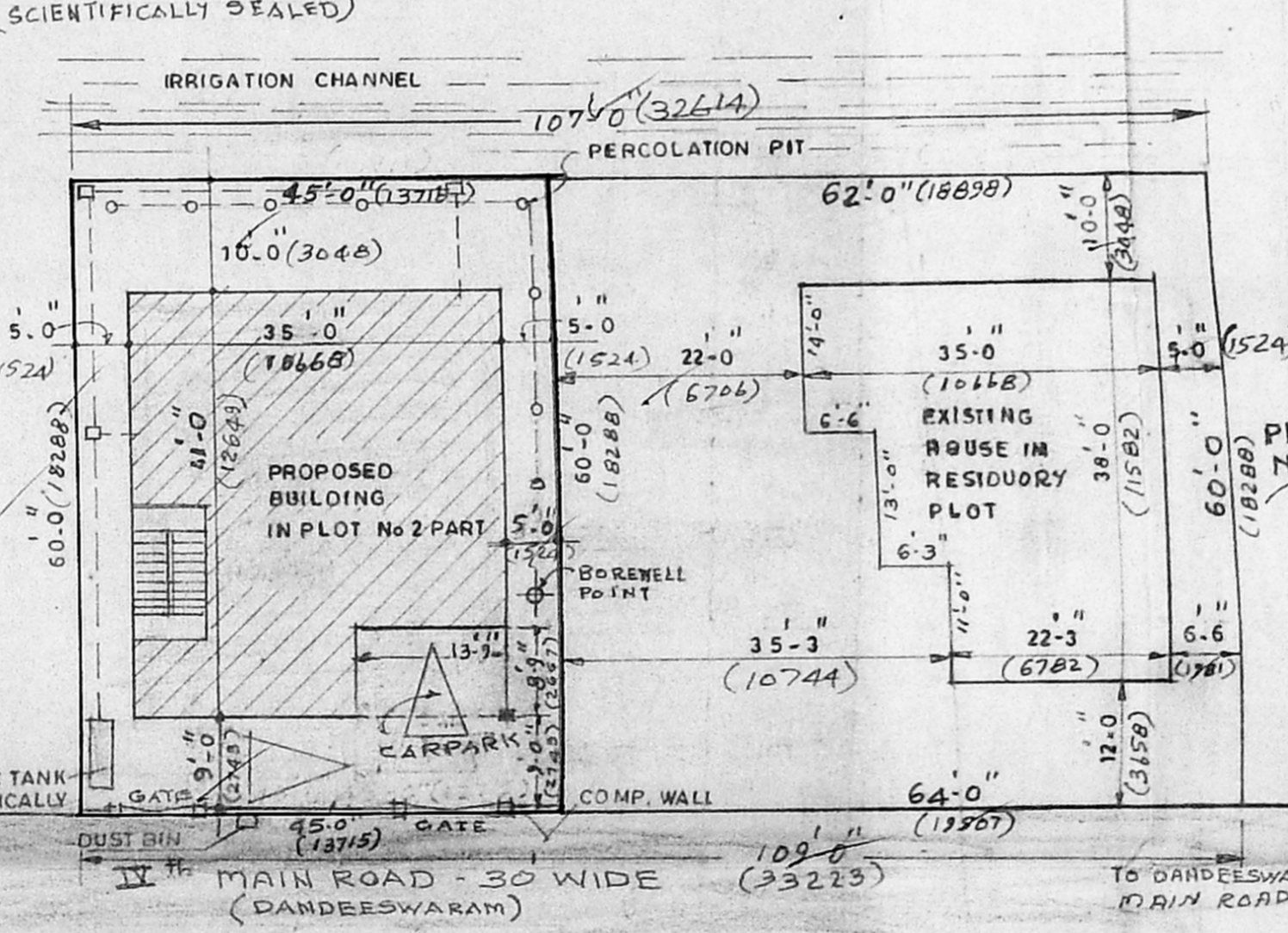
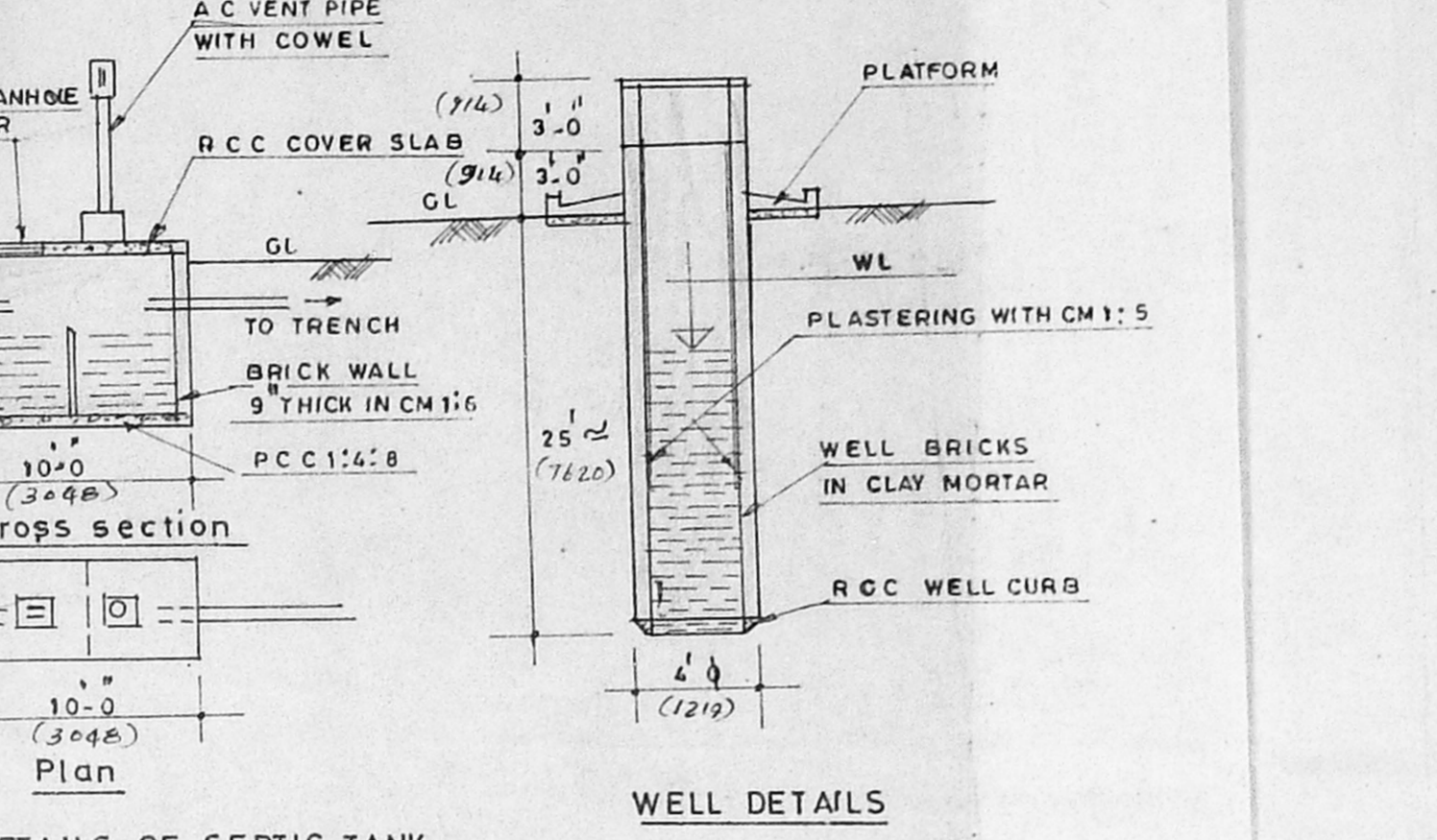
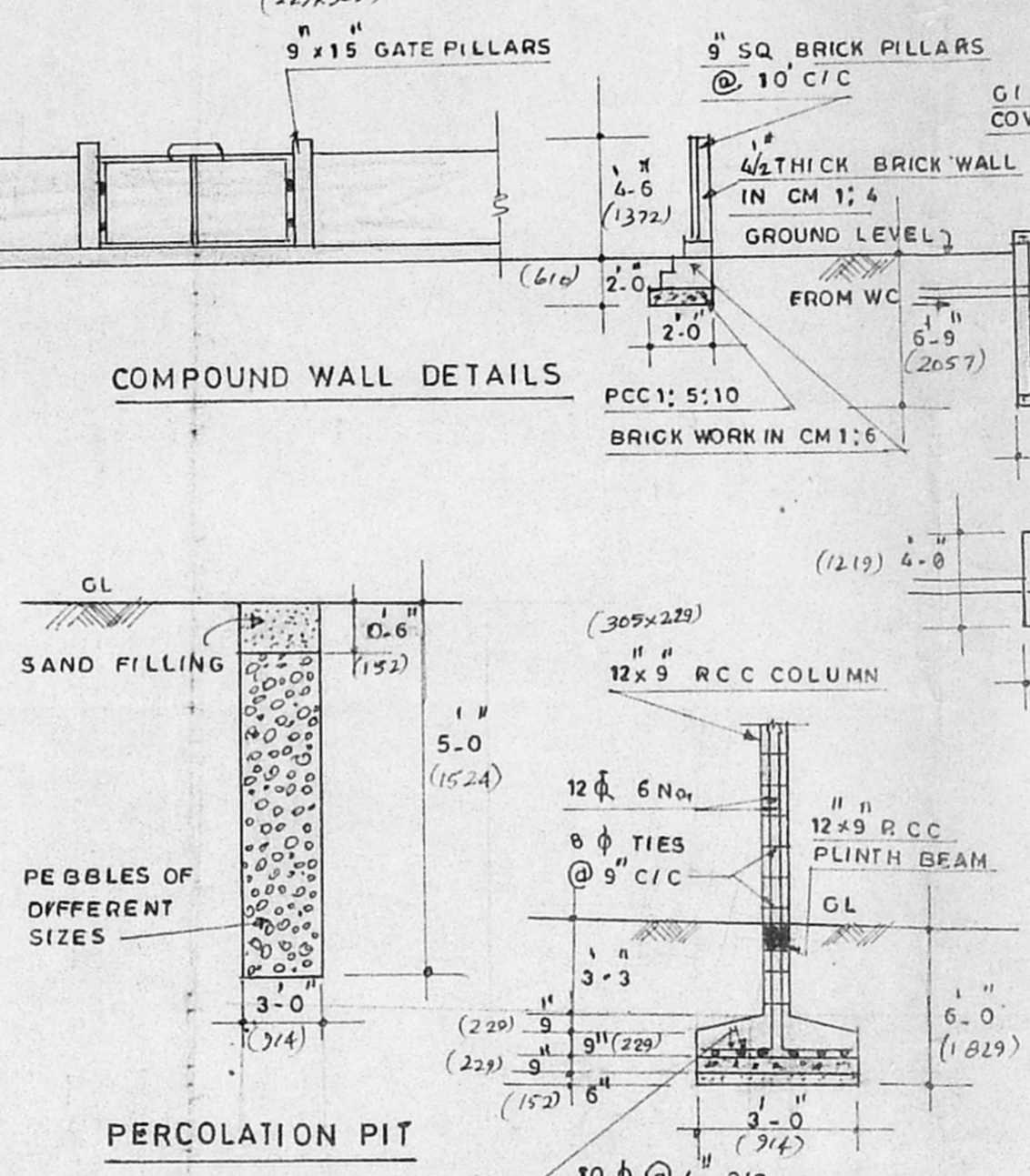
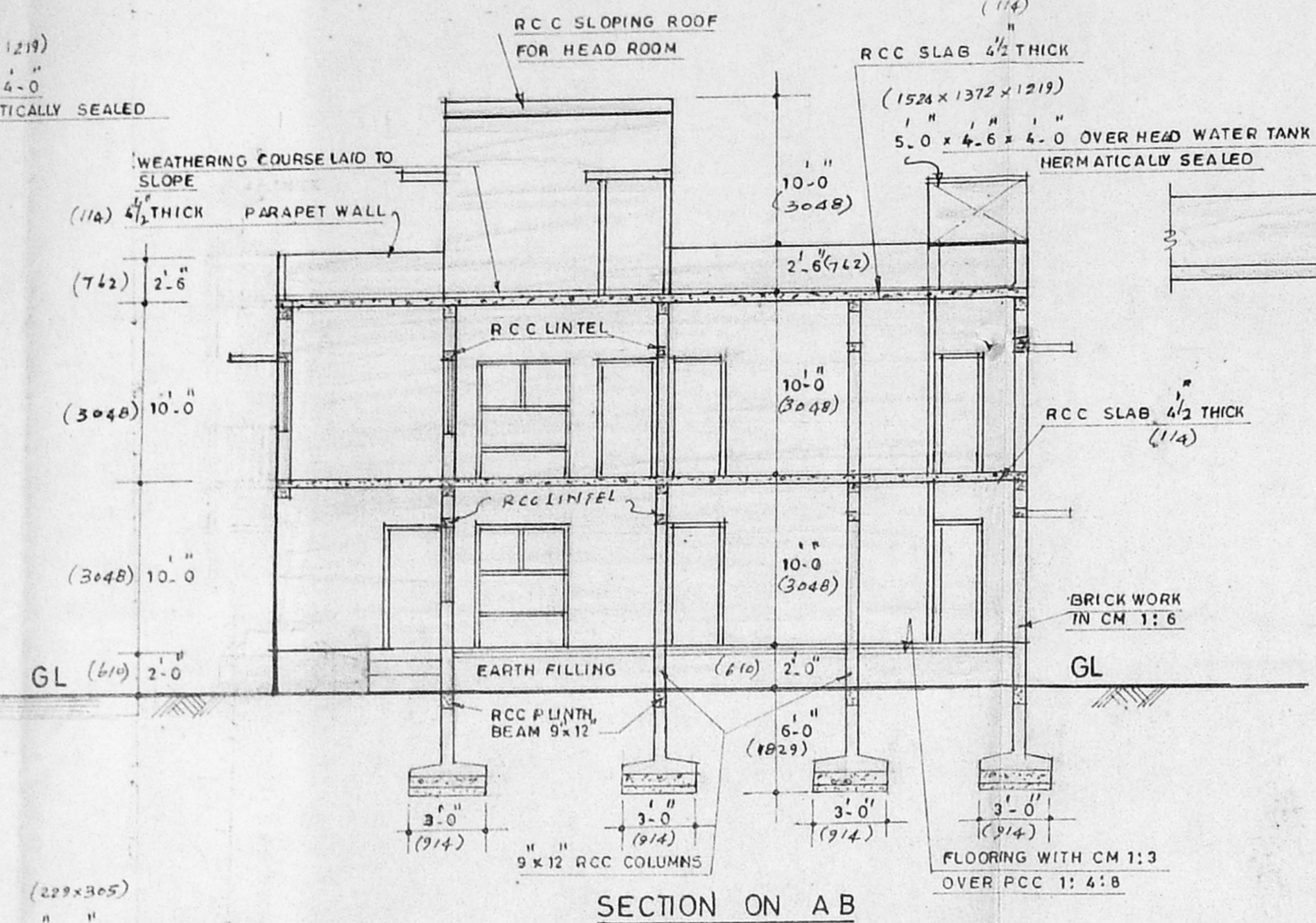
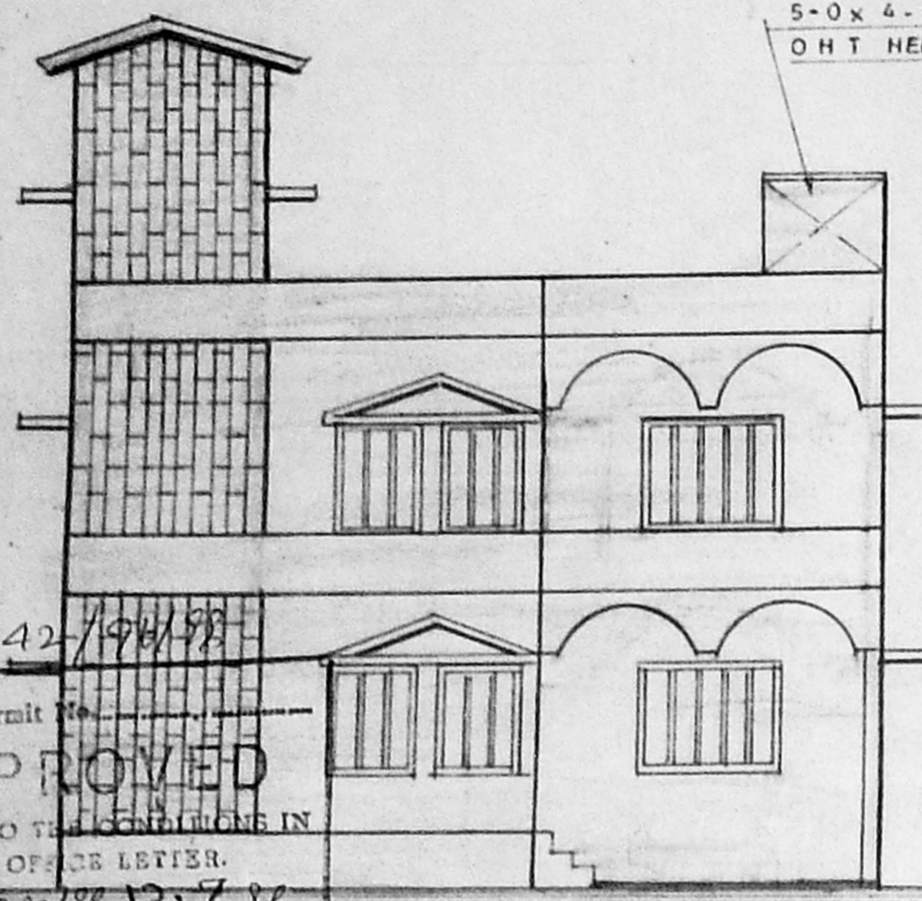

**SCHEDULE OF JOINERY**

1. D	DOOR	3'-6" x 7'-0"	(1067 x 2134)
2. D <sub>1</sub>	DOOR	3'-0" x 7'-0"	(914 x 2134)
3. D <sub>2</sub>	DOOR	2'-6" x 7'-0"	(762 x 2134)
4. W	WINDOW	6'-0" x 4'-6"	(1829 x 1372)
5. W <sub>1</sub>	WINDOW	5'-0" x 4'-5"	(1524 x 1372)
6. W <sub>2</sub>	WINDOW	3'-0" x 4'-5"	(914 x 1372)
7. W <sub>3</sub>	WINDOW	3'-0" x 3'-6"	(914 x 1067)
8. V	VENTILATOR	2'-0" x 1'-5"	(610 x 457)
9. J	RCC JALY	8'-0" x 7'-3"	(2438 x 2134)
10. WR	WARD ROBE	2'-0" x 7'-0"	(1219 x 2134)

**COLOUR CODE REFERENCE**

PROPOSED CONSTRUCTION  
 EXISTING ROAD  
 PLOT BOUNDARY

**AREA STATEMENT**

PLOT AREA = 2700 SFT (251 M<sup>2</sup>)

GROUND FLOOR 1470 SFT (136.6 M<sup>2</sup>)

FIRST FLOOR 1470 SFT (136.6 M<sup>2</sup>)

TOTAL 2940 SFT (273.2 M<sup>2</sup>)

PLOT COVERAGE = 54%

FSI = 1.09

**RESIDUARY PLOT DETAILS :**

PLOT AREA = 3780 SFT.

BUILDING AREA = GF=1235 SFT, FF=1235 SFT.

PLOT COVERAGE = 32.6%, FSI = 0.65

**PLAN SHOWING THE PROPOSED DWELLING HOUSE ON PLOT No. 2 part, IVth MAIN ROAD DANDEESWAM COMPRISED IN S.No.203/2 part APPROVED AND SACTIONED BY DDTP No.21/70 AT VELACHERY CHENNAI-42 DIVISION No.153 ZONE No. X**

(SCALE 1" = 8'-0")

**LICENSED SURVEYOR**  
 R. Mohan Rao  
 LICENSED SURVEYOR  
 CO-OP. T.O. OF CHENNAI  
 REG NO. 80  
 AMBATTUR TOWNSHIP  
 ALANDUR M.U. LIY  
 CONSULTING ENGINEER  
 OFFICE: 15, MADLEY ROAD  
 T. NAGAR, CHENNAI-600 017

**OWNER**  
 U. Sarla  
 S. Urimala